



# Summit Agenda

## Breakout Sessions & Room Designations

Salon A	Track 1
Salon B	Track 2
Salon C	Track 3
Salon D	Wildfire Interface: Workshop 8 Hrs

Tuesday, June 03, 2014

8:00 am - 5:00 pm	Registration and Exhibitor Hall Open				
8:30am - 10:45 am	Exhibits Open	<p>Opening Ceremonies</p> <p>Plenary Session</p> <p><b>Keynote Address: Tony Robinson, FEMA Region VI</b>  <b>Michelann Ooten, Oklahoma Emergency Management</b>  <b>Robert Holden, National Congress of American Indians</b>  <b>Rick Smith, National Weather Service</b>  <b>Jon Wickersham, TransCanada " A Comprehensive Approach to Response"</b></p> <p>(Grand Ballroom)</p>			
		Salon A	Salon B	Salon C	Salon D
11:00 am - 12:00 pm		<p>Ham Radio and Emergency Response</p> <p>Lloyd Colston</p>	<p>Therapy Dogs</p> <p>Bruce Storm</p>	<p>Animal Response and Recovery in a Disaster</p> <p>Dr. Leslie Cole</p>	<p>Wildfire Interface: Workshop 8 Credit Hours</p> <p>Jared Williams, ClintWagstaff</p>
12:00 pm - 1:00pm		Lunch Break			
1:00 pm - 1:50 pm		<p>Ok FIRST: Mesonet</p> <p>James Hocker</p>	<p>Red Cross &amp; FEMA National Mass Care Strategies</p> <p>Chele Rider, Justin Breeding</p>	<p>Animal Issues in Severe Climatic Circumstances</p> <p>Dr. Leslie Cole</p>	<p>WildFire Interface: Workshop 8 Credit Hours (PART 1)</p>
2:00 pm - 2:50 pm		<p>OK Fire</p> <p>JD Carlson</p>	<p>Red Cross &amp; FEMA Partnering Locally in Mass Care</p> <p>James Tittle Samantha Henry Rene Beezley Carrie Norton</p>	<p>FEMA Region VI Tribal Declaration Pilot Guide Consultation with Tribes</p>	<p>Wildfire Interface: Workshop 8 Credit Hours (PART 1)</p>
3:00 pm - 3:50 pm		<p>Therapy Dogs</p> <p>Bruce Storm</p>			<p>Wildfire Interface: Workshop 8 Credit Hours (PART 2)</p>
3:50 pm - 5:00 pm	End of Sessions: Networking and Visit with Vendors				

Wednesday, June 04, 2014

8:00 am - 5:00 pm	Registration and Exhibition Hall Open			
8:30 am - 10:45 am	<p style="text-align: center;">Plenary Session  <b>Steve Golubic, National Tribal Emergency Management Council</b>  <b>Bobby Gonzalez, Trans Canada, Indigenous Nations Policy: Community Investments Working with Native American Communities</b>  <b>Dore Beitz, iTEMA</b>  <b>63<sup>rd</sup> Support</b></p> <p style="text-align: center;">(Grand Ballroom)</p>			
	Salon A	Salon B	Salon C	Salon D
11:00 am - 12:00 pm	<b>Dr. Gary Webb, PhD</b> Fostering Flexibility Amidst All of the Bureaucratization, Centralization, and Standardization of Emergency Management	<b>Southern Baptist            Relief</b> <b>Working with VOADS            in Disaster</b>  <b>Sam Porter</b>	<b>Oklahoma            Emergency            Management</b>  <b>When There Is A            Disaster Who Do            You Call?</b>	<b>Wildfire Interface:            Workshop 8 Credit            Hours (PART 2)</b>  <b>Jared Williams            Clint Wagstaff</b>
12:00 pm - 1:00 pm	Lunch Break			
1:00 pm - 1:50 pm	<b>Earthquakes:            Seismic Event            Preparedness and            Recovery</b>  <b>Will Post</b>	<b>Firewise Community            Grants</b>  <b>Stephen Mattax</b>	<b>Oklahoma            Emergency            Management</b>  <b>PA, IA, HM/SBA and            all the steps in            between</b> <b>Art Jones &amp; Crew</b>	<b>Wildfire Interface:            Workshop 8 Credit            Hours (PART 2)</b>  <b>Jared Williams            Clint Wagstaff</b>
2:00 pm - 2:50 pm	<b>USGS Real-Time            Flood Monitoring</b>  <b>Bill Andrews            Jason Lewis</b>	<b>FEMA:NIMS</b>  <b>Mike Goldsworthy            Sam Garland</b>	<b>OEM Continues</b>  <b>Follow A Disaster</b>	<b>Wildfire Interface:            Workshop 8 Credit            Hours (PART 2)</b>
3:00 pm - 3:50 pm	<b>Climate Center:            Drought Tools and            Resources</b>  <b>April Taylor            Rachel Riley</b>	<b>FEMA Continues:            THIRA</b>  <b>Chad Johnston            Brian Ellis</b>	<b>OEM Continues</b>  <b>From Beginning to            Finish</b>	<b>Wildfire Interface:            Workshop 8 Credit            Hours (Part 2)</b>
3:50 pm - 5:00 pm	End of Sessions: Networking and Visit with Vendors			

Thursday, June 05, 2014

8:00 am - 11:00 am	Registration and Exhibition Hall Open	
8:30 am - 11:00 am	Exhibits Open	Plenary Session Mike Callahan, Disaster Recovery: Fire and Water Recovery Tulsa Corps of Engineers, Emergency Power Facility Assessment Tool (EPFAT) Tom Bergman, Mapping A Disaster: Cameo and Marplot for Emergency Management Monty Elder, Local Emergency Planning Committee: Making Your Community Strong in the Face of the Storm Jennifer Newell, Oklahoma School Security Institute: Safety in Schools Steve Ford, Cyber Terrorism: Protecting Your Private Information  (Grand Ballroom)
11:00 am - 12:00 pm	Closing Ceremonies and Door Prizes	

<<<<<<<<<< **SPONSORS** >>>>>>>>>>

ALLIANT INSURANCE SERVICES

BROWN & BROWN INSURANCE

SOUTHWEST PERLC

TRANSCANADA

<<<<<<<<<< **VENDORS** >>>>>>>>>>

- |                                   |                                  |                          |
|-----------------------------------|----------------------------------|--------------------------|
| AMERICAN RED CROSS                | HAZARD MITIGATION SPECIALISTS    | POTT CO HEALTH DEPT      |
| ASSOCIATED PROFESSIONAL SERVICES  | KAW NATION SOUTHWIND ENERGY, LLC | SE OK ARES               |
| CASCO INDUSTRIES                  | LMC CORPORATION                  | SERVPRO OF NORMAN        |
| CHLOETA FIRE                      | MUSCOGEE CREEK NATION GIS        | SULLIVAN INSURANCE       |
| CHICKASAW PERSONAL COMMUNICATIONS | MIDWEST CARD                     | SURVIVE-A-STORM SHELTERS |
| FIRSTCALL                         | OKLAHOMA STATE DEPT HEALTH       | TORNADO SHELTERS         |
| FEMA REGION 6                     | PAGE PLUS                        |                          |

## ABOUT ITEMC

ITEMC was formed in December 2004 as a learning and networking resource for Tribal Emergency Management professionals. Because of the checker-board layout of our tribal lands, the need for networking, enhancing and strengthening our working relationships with Federal, State, County and City governments soon became paramount. The first Summit was held in June 2008 with about 180 attendees and has grown each year. The Summits are designed to help those involved in Emergency Management to overcome misconceptions about jurisdictional boundaries, organization, tribal resources, and receiving federal assistance. It has evolved into an excellent opportunity for Tribal, Federal, State, and local officials to network with other agencies and organizations.

**THANK YOU TO ALL THE ATTENDEES, SPEAKERS, VENDORS AND SPONSORS FOR MAKING THIS ANOTHER SUCCESSFUL ITEMC SUMMIT!**

### OKLAHOMA FEDERALLY RECOGNIZED TRIBES

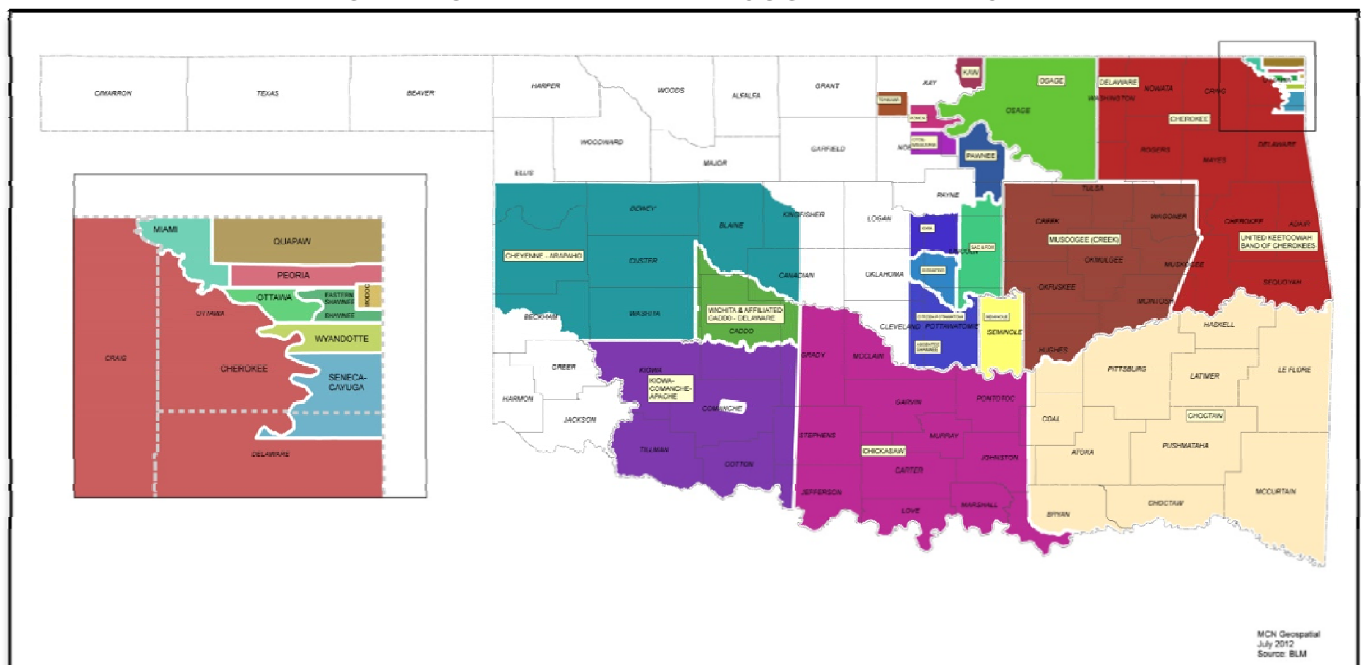

ABSENTEE SHAWNEE TRIBE  
 ALABAMA QUASSARTE TRIBAL TOWN  
 APACHE TRIBE  
 CADDO NATION  
 CHEROKEE NATION  
 CHEYENNE-ARAPAHO TRIBES  
 CHICKASAW NATION  
 CHOCTAW NATION  
 CITIZEN POTAWATOMI NATION  
 COMANCHE NATION  
 DELAWARE NATION  
 DELAWARE TRIBE  
 EASTERN SHAWNEE TRIBE

FORT SILL APACHE TRIBE  
 IOWA TRIBE  
 KAW NATION  
 KIALEGEE TRIBAL TOWN  
 KICKAPOO TRIBE  
 KIOWA TRIBE  
 MIAMI TRIBE  
 MODOC TRIBE  
 MUSCOGEE CREEK NATION  
 OSAGE NATION  
 OTTAWA TRIBE  
 OTOE-MISSOURIA TRIBE  
 PAWNEE NATION

PEORIA TRIBE  
 PONCA TRIBE  
 QUAPAW TRIBE  
 SAC & FOX NATION  
 SEMINOLE NATION  
 SENECA CAYUGA TRIBE  
 SHAWNEE TRIBE  
 THLOPHTLOCCO TRIBAL TOWN  
 TONKAWA TRIBE  
 UNITED KEETOOWAH BAND  
 OF CHEROKEE INDIANS  
 WICHITA & AFFILIATED TRIBES  
 WYANDOTTE NATION

## ACKNOWLEDGEMENT

# Southwest Preparedness and Emergency Response Learning Center and the Centers for Disease Control and Prevention

Funding for this conference was made possible (in part) by the Southwest Preparedness and Emergency Response Learning Center and the Centers for Disease Control and Prevention. The views expressed in written conference materials or publications and by speakers and moderators do not necessarily reflect the official policies of the Department of Health and Human Services, nor does the mention of trade names, commercial practices, or organizations imply endorsement by the U.S. Government.

### MOBILE UNITS (OUTSIDE - WEST SIDE OF EVENT CENTER) FOR TOURS

BIA FIREFIGHTERS TRAILER  
CITIZEN POTAWTOMI NATION MEDI FLIGHT HELICOPTER  
CHOCTAW NATION 1<sup>ST</sup> RESPONDER TRAILER

IOWA TRIBE BRUSH VEHICLE  
KIAMICHI TECHNOLOGY CENTERS:  
DISASTER RESPONSE EMS TRAINING  
SIMULATOR/ TRAILER

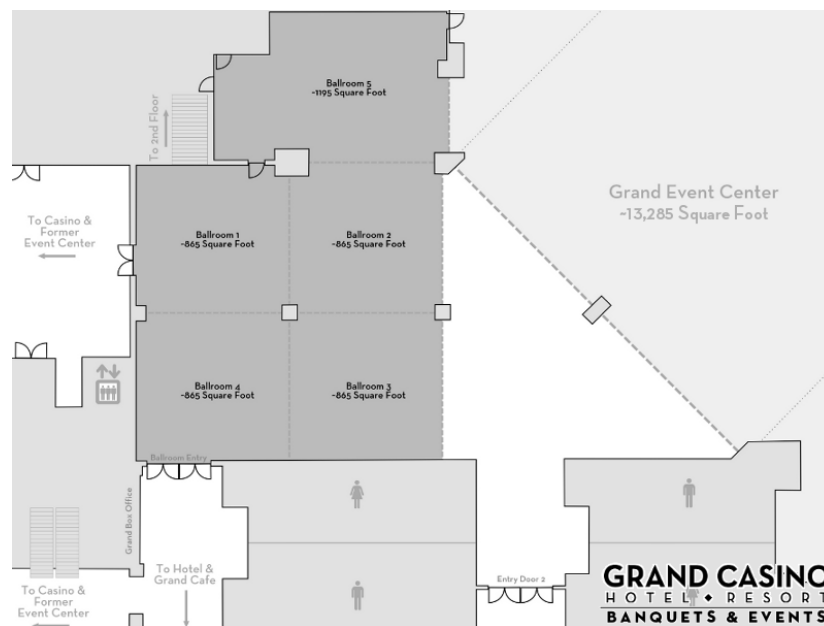

MEETING ROOM FLOOR PLAN